

3/8" CAULKED EXPANSION JOINT IN PAVING OVER CONCRETE BASE EXPANSION JOINT AT 30' O.C. MAX.

SECTION

1"=1'

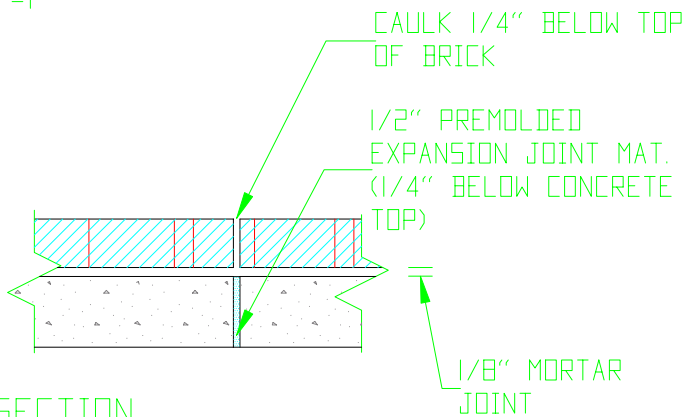

CAULK 1/4" BELOW TOP OF BRICK

1/2" PREFORMED EXPANSION JOINT MAT. (1/4" BELOW CONCRETE TOP)

1/8" MORTAR JOINT

\*PROVIDE CROSS SLOPE: 1/5% MIN. 2% MAX.

GUIDELINES REGARDING THE SELECTION OF BRICK PATTERNS FOR WALLS AND PAVED AREAS SHALL BE BASED ON THE 1998 MASTER LANDSCAPE PLAN.

STANDARD BRICK PAVING PATTERN SHALL BE HERRINGBONE BUTT JOINTS WITH A STANDARD JOINT WIDTH OF 1/8". TYPICAL BRICK PAVING PATTERN IS HERRINGBONE WITH BUTT JOINTS (1/8" WIDTH JOINT), BORDER (EDGE) BRICKS SET WITH 3/8" FULL MORTAR JOINTS. (BRICK PATTERN TO BE DETERMINED AS DESIGN CRITERIA BY OFFICE OF THE ARCHITECT FOR THE UNIVERSITY.)

SECTION

N.T.S.

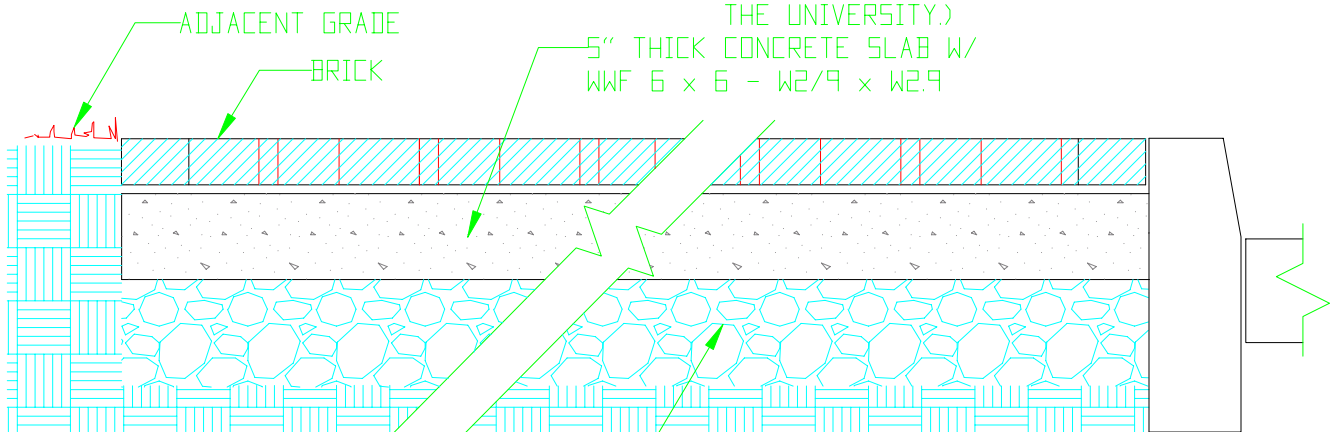

ADJACENT GRADE

BRICK

5" THICK CONCRETE SLAB W/ WWF 6 x 6 - W2/9 x W2.9

6" COMPACTED AGGREGATE BASE, VDOT # 21A ON COMPACTED SUBGRADE

SECTION

1"=1'

BRICK WALK PAVING